

Security Technology with KNX

Bastec s.a.r.l.

Strassen, Luxemburg

BASTE sarl is a service and system integration company for building automation systems in Luxemburg and is focused in the field of KNX, LCN and other building systems. The projects are not limited to the region. The company covers the most important European languages with French, English, German, Italian and some Spanish. The company has realized over time that it is not just about switching lights on and off in homes. Building owners are increasingly more interested in individual design that includes the integration of lights, shutters and blinds into scenes.

This puts the actual life into a building. The systems can be adapted to the changing needs of the people that live in the buildings and that is an important aspect. Today's needs can be very different than tomorrow's needs. Today all these solutions can be implemented for people that do not want to spent a lot of money to retrofit their home. Expandable systems still offer these customers a comfortable home. In collaboration with strong partners, it is possible to cover new areas and extend the boundaries. The experience and the individual solutions of every supplier contribute to it. The company has found a partner like that with GePro and their control panel products. The constant exchange of ideas enables both companies to keep an individual profile.

School of Hotel Management Diekirch „Alexis Heck“

The School of Hotel Management Diekirch was equipped with a fire protection system and new safety technology based on the KNX system as part of a retrofit effort. The control of the corridor lights by motion detectors, the exterior light control by light sensors and timer and the linkage to the Elvis visualization system were installed. It was important to the planner to offer a simple and



Figure 1. This is what the system control looked like before the retrofitting with the GePro control panel and the Elvis visualization. The connection and programming of the system is performed through Elvis in the background.

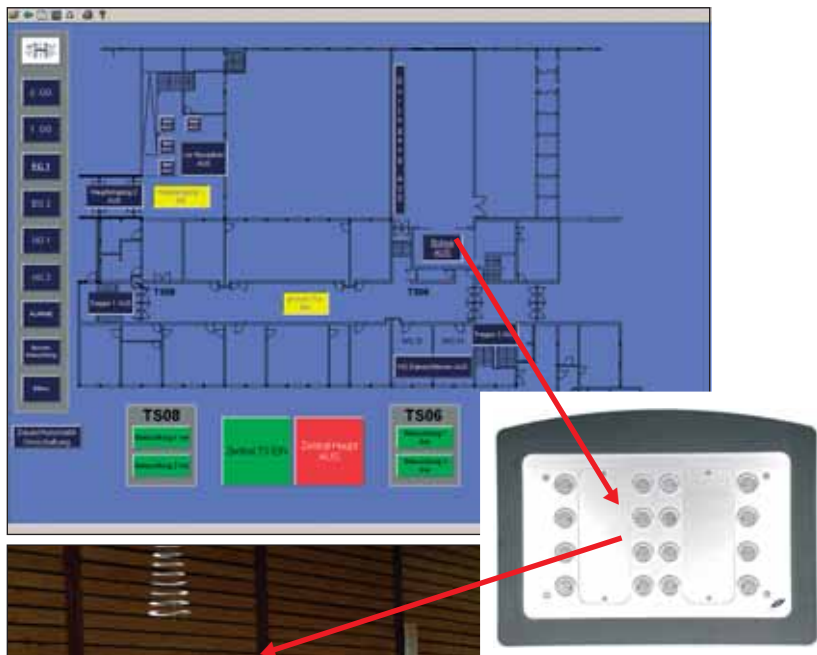

The 16x GePro Panel controls the large ballroom and the entire stage lighting system. This ensures a cost efficient and simple operation by the user or by actors on stage.

The navigation bar on every page guides the user through the entire visualization.



The 16x GePro Panel controls the large ballroom and the entire stage lighting system. This ensures a cost efficient and simple operation by the user or by actors on stage.

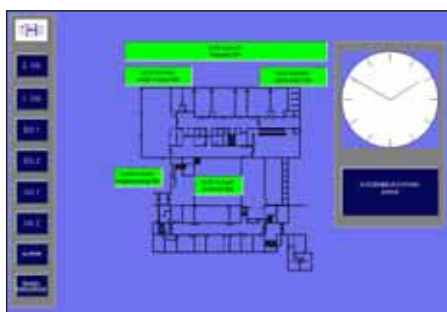

The alarm and system operation status can be displayed centrally through the visualization. The exterior lighting can be controlled automatically by settings in the visualization or manually.

efficient solution to the customer. Since this was not possible in all areas with Elvis, GePro control panels were used instead. In this case, a 16x on-wall control panel with LED display was installed which controls the entire ballroom, including the stage lighting. The users can now easily control all the important areas without previous technical knowledge. Central commands make the operation very easy for the employees. The installation of the control panel was a very cost efficient and economical solution.

Currently the system is converted to work in server-terminal mode. Then it will be possible for the janitor to work from home, e.g. during events and it will be possible to turn everything off remotely.